

PROFILE

STANDARD SPECIFICATIONS

ENDS

Molded resin acrylic, secured to the diffuser with a two part adhesive, and the diffuser assembly snaps in place over spring steel clips for tool less maintenance.

HOUSING

Cold rolled steel, die-formed assembly. The housing can be mounted horizontal or vertical.

DIFFUSER

UV stabilized white acrylic. The material can withstand minor impact without breaking.

LED PERFORMANCE - 3500K STANDARD

120-277V - 3500K, 82 CRI - L80 rating - 60,000 hrs - L70 rating (projected) - 100,000 hrs
 Amperage rated @ 110V input
 Operating ambient temperature: -20°C / -4°F - 40°C / 104°F

Delivered 3500K lumens noted. Consult Brownlee.com for performance of all CCTs.

H16 - 16W nominal, .14 A input - 1763 lm. Dimmable (0-10V).

H25 - 25W nominal, .20 A input - 2603 lm. Dimmable (0-10V).

H32 - 32W nominal, .26 A input - 3490 lm. Dimmable (0-10V).

MOUNTING

Fixture uses wall anchors (by others) appropriate for the mounting surface.

FINISH

The 5038 series is available in all Brownlee paint finishes as a standard offering.

WARRANTY

5 year limited warranty on this LED product. Consult factory for details.

PROJECT:
MODEL #:
FIXTURE TYPE:



NT endcaps, WHA diffuser

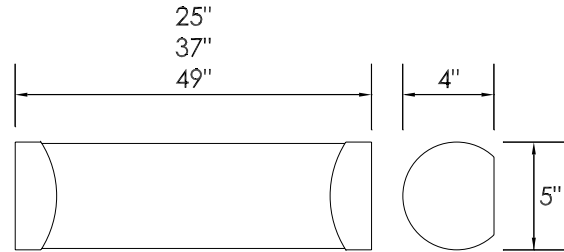

ORDERING INFORMATION



DAMP



5038 - _____
 Model 2. 3. 4. 5. 6. (if required)

2. SIZE

25 L: 25"
37 L: 37"
49 L: 49"

3. ENDCAPS

STANDARD

BL Black
BZ Bronze
GM Gun Metal
MB Metallic Bronze
NT Nickel Tone
PL Platinum
WH White

CUSTOM

Provide color sample or RAL code to match

4. WATTAGE

25 SIZE
H16 16W H Series LED

37 SIZE
H25 25W H Series LED

49 SIZE
H32 32W H Series LED

5. COLOR TEMPERATURE

35K 3500K standard color temperature
30K 3000K color temperature
40K 4000K color temperature

6. AVAILABLE OPTIONS

90R⁰ 90 CRI (3000K only)
BAC¹ Buy American Compliant
BBI^{2*} Integral Battery Backup (H25 & H32 only)
DTR⁴ Triac (Line Voltage) Dimming (120V)
ES⁶ ENERGY STAR® (Not available in 90 CRI)
FCL⁷ French Canadian Labels

Notes: (0) **90R** - cannot be combined with ES. (1) **BAC** - cannot be combined with FCL. (2) **BBI/BBS/BBC** - cannot be combined with ECW, EXT, or T24. (3) **BLD** - includes integral OCC sensor (do not combine with OCC option). Cannot be combined with DTR or T24. (4) **DTR** - cannot be combined with BLD or T24. (5) **ECW** - cannot be combined with BBI, BBC, or DTR. (6) **ES** - cannot be combined with 90R or T24. (7) **FCL** - cannot be combined with BAC or T24. (8) **OCC** - integral ON/OFF occupancy sensor. (9) **T24** - includes JA8 labeling and 90 CRI LEDs (do not combine with 90R option). Cannot be combined with BBI, BBC, BBS, BLD, DTR, ES, or FCL. (10) **BBS** - cannot be combined with BLD, ECW, EXT, OCC, or T24. (11) **PCH/PC4** - cannot be combined with BLD or OCC.
Add'l Notes: ***BBI/BBS/BBC** - standard BBI (and BBS) option has a minimum operating temperature of 10C/50F. BBC option has a minimum operating temperature of -20C/-4F. ****BLD** - integral OCC sensor with onboard control. 1: Motion is detected, illuminate to 100%. 2: Motion no longer detected, dim to 50% (factory default), 30%, 20% or 10%. 3: Remain in continuous dimmed state (factory default) or turn off after set period.
Specifications and dimensions subject to change without notice.
 Consult your Brownlee Lighting representative for availability and ordering information.



REVISED
2020.12.23