

1572 LED

The 1572 LED features a smooth arced profile with vertically mirrored bows which produce a symmetrical LED wall wash. Perfect for common areas and corridors in commercial offices, hotels and residential spaces. This unit features acrylic top and bottom covers to protect the light source.

Refer to model #: 2080 LED and 2680 LED for coordinating ceiling series.

FINISHES



BOW

STANDARD SPECIFICATIONS

FRAME + BACKPLATE

Formed, cold rolled steel. Outer frame contains no exposed hardware. Slim 3.5" projection from wall.

DIFFUSER

UV stabilized acrylic top and bottom diffusers.

LED PERFORMANCE - 3500K STANDARD

120-277V - 3500K, 82 CRI - L80 rating - 60,000 hrs - L70 rating (projected) - 100,000 hrs

Amperage rated @ 110V input

Operating ambient temperature: -20°C / -4°F - 40°C / 104°F

Delivered 3500K lumens noted. Consult Brownlee.com for performance of all CCTs.

Dual Direction Distribution

B12 - 12W nominal, .10 A input - 534 lm. Dimmable (0-10V).

MOUNTING

Fixture mounts directly to j-box (by others).

FINISH

The 1570 frame and backplate are offered in a variety of powder coat finishes.

Installation outdoors voids the Brownlee Limited Warranty.

WARRANTY

5 year limited warranty on this LED product. Consult factory for details.

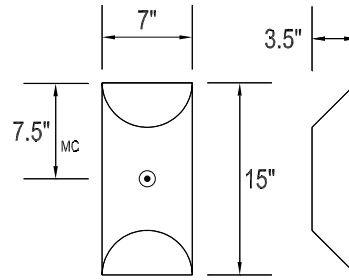

White Out | Nickel Tone In



DAMP



ORDERING INFORMATION

1572	-	-	-	-	-	-
Model	2.	3.	4.	5.	6.	

2. OUTER FINISH

BL	Black
BU	Pastel Blue
GN	Pastel Green
MG	Metallic Gold
NT	Nickel Tone
RD	Red
WH	White
YL	Yellow

CUSTOM

Provide color sample or RAL code to match

Note: Brushed Nickel (BN) is no longer a standard offering on this model. Contact factory for availability.

3. WATTAGE

B12 12W B Series LED

4. INNER FINISH

BL	Black
BU	Pastel Blue
GN	Pastel Green
MG	Metallic Gold
NT	Nickel Tone
RD	Red
WH	White
YL	Yellow

5. COLOR TEMPERATURE

35K	3500K standard color temperature
27K	2700K color temperature
30K	3000K color temperature
40K	4000K color temperature

6. AVAILABLE OPTIONS

90R ⁰	90 CRI (3000K only)
BAB ¹	Build America, Buy America Compliant (BABAA) (Exclusions: DTR - contact factory)
BAC ¹	Buy American Compliant (BAA)
DTR ⁴	Triac (Line Voltage) Dimming (120V)
FCL ⁷	French Canadian Label
T24 ⁹	Title 24 JA8 Compliant (B12 in 3000K only)

Universal Footnotes (only applies if superscript is shown in Options section): (0) 90R - All LEDs/CCTs are being transitioned to 90 CRI standard over 2025. Inquire for this model's availability. (1) BAC/BAB - www.brownlee.com/resources/usa. (2) BBI/BBC - cannot combine with ECW or EXT. (3) BLD - integral microwave motion sensor (step-dim). Cannot combine with DTR. (4) DTR - cannot combine with BLD. (5) ECW - cannot combine with BBI, BBC, or DTR. (7) FCL - cannot combine with BAC. (8) OCC - integral microwave motion sensor (ON/OFF). (9) T24 - includes JA8 labeling and 90 CRI LEDs. (10) PCH/PC4 - cannot combine with BLD or OCC.

Add'l Notes: *BBI/BBC - BBI minimum operating temp: 10C/50F unless otherwise stated. BBC minimum operating temp: -20C/-4F.

**BLD - integral microwave motion sensor with step-dim control. 1: Motion is detected, illuminate to 100%.

2: Motion no longer detected, dim to set level. 3: Remain in continuous dimmed state or turn off after set period. Config. via onboard dip switches.

Specifications subject to change without notice.