

GLIDE TWO

STANDARD SPECIFICATIONS

FRAME

Cold rolled steel, roll formed and assembled with rivets. The assembly has multiple stiffening edges for durability.

DIFFUSER

Translucent, UV stabilized white acrylic. The material is flexible to withstand minor impact without breaking.

PAN

Formed, cold rolled steel design, finished with a powder coat high reflectance white paint.

LED PERFORMANCE - 3500K STANDARD

120-277V - 3500K, 82 CRI - L80 rating - 60,000 hrs - L70 rating (projected) - 100,000 hrs
 Amperage rated @ 110V input
 Operating ambient temperature: -20°C / -4°F - 40°C / 104°F

Delivered 3500K lumens noted. Consult Brownlee.com for performance of all CCTs.
 B06 - 6W nominal, .05 A input - 761 lm. Non-dimming.
 B12 - 12W nominal, .10 A input - 1504 lm. Dimmable (0-10V).
 C09 - 9W nominal, .10 A input - 1061 lm. Dimmable (0-10V).

MOUNTING

Directly to j-box (by others). Mounting hardware included.

FINISH

The 1518 series is available in all Brownlee paint finishes as a standard offering.

WARRANTY

5 year limited warranty on this LED product. Consult factory for details.

PROJECT:
MODEL #:
FIXTURE TYPE:



NT finish

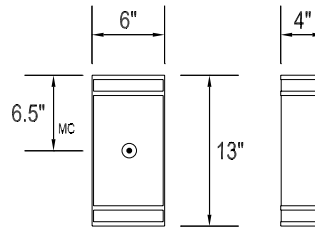

DAMP



ORDERING INFORMATION

1518 - _____
 Model 2. 3. 4. 5.

2. FINISH	3. WATTAGE	4. COLOR TEMPERATURE	5. AVAILABLE OPTIONS
STANDARD AB Antique Bronze AS Antique Silver BL Black BZ Bronze DB Desert Bronze GM Gun Metal MB Metallic Bronze MG Metallic Gold NT Nickel Tone PL Platinum WH White CUSTOM Provide color sample or RAL code to match	B06 6W B Series LED B12 12W B Series LED C09 9W C Series LED	35K 3500K standard color temperature 27K 2700K color temperature 30K 3000K color temperature 40K 4000K color temperature	90R⁰ 90 CRI (3000K only) BAC¹ Buy American Compliant DTR⁴ Triac (Line Voltage) Dimming (120V)(All except B06) ES⁶ ENERGY STAR® (Not available in 90 CRI) FCL⁷ French Canadian Labels T24⁹ Title 24 JA8 Compliant (B12 in 3000K only) TBC Top/Bottom Covers (Perforated)

Notes: (0) 90R - cannot be combined with ES. (1) BAC - cannot be combined with FCL. (2) BBI/BBS/BBC - cannot be combined with ECW, EXT, or T24. (3) BLD - includes integral OCC sensor (do not combine with OCC option). Cannot be combined with DTR or T24. (4) DTR - cannot be combined with BLD or T24. (5) ECW - cannot be combined with BBI, BBC, or DTR. (6) ES - cannot be combined with 90R or T24. (7) FCL - cannot be combined with BAC or T24. (8) OCC - integral ON/OFF occupancy sensor. (9) T24 - includes JA8 labeling and 90 CRI LEDs (do not combine with 90R option). Cannot be combined with BBI, BBC, BBS, BLD, DTR, ES, or FCL. (10) BBS - cannot be combined with BLD, ECW, EXT, OCC, or T24. (11) PCH/PC4 - cannot be combined with BLD or OCC.
Add'l Notes: *BBI/BBS/BBC - standard BBI (and BBS) option has a minimum operating temperature of 10C/50F. BBC option has a minimum operating temperature of -20C/-4F. **BLD - integral OCC sensor with onboard control. 1: Motion is detected, illuminate to 100%. 2: Motion no longer detected, dim to 50% (factory default), 30%, 20% or 10%. 3: Remain in continuous dimmed state (factory default) or turn off after set period.

Specifications and dimensions subject to change without notice.
 Consult your Brownlee Lighting representative for availability and ordering information.

