

# STAMP

## STANDARD SPECIFICATIONS

### DIFFUSER

Sturdy injection molded white acrylic design. UV stabilized.

### PAN

The die formed aluminum pan resists rust and has a high reflectance white powder coat surface.

### LED PERFORMANCE - 3500K STANDARD

120-277V - 3500K, 82 CRI - L80 rating - 60,000 hrs - L70 rating (projected) - 100,000 hrs  
 Amperage rated @ 110V input  
 Operating ambient temperature: -20°C / -4°F - 40°C / 104°F

Standard 3500K source lumens noted. Consult Brownlee.com for performance of all CCTs.

B06 - 6W nominal, .05 A input - 875 lm. Non-dimming.  
 B12 - 12W nominal, .10 A input - 1730 lm. Dimmable (0-10V).  
 C09 - 9W nominal, .10 A input - 1220 lm. Dimmable (0-10V).

### MOUNTING

Directly to j-box (by others). Mounting hardware included.

### WARRANTY

5 year limited warranty on this LED product. Consult factory for details.

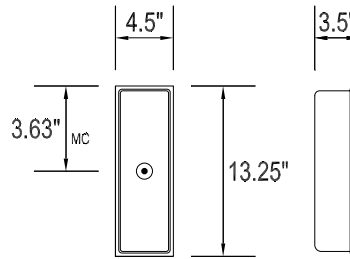

**DAMP**



## ORDERING INFORMATION

**1040** - \_\_\_\_\_  
 Model                      2.                      3.                      4.

### 2. WATTAGE

**B06**    6W B Series LED  
**B12**    12W B Series LED  
**C09**    9W C Series LED

### 3. COLOR TEMPERATURE

**35K**    3500K standard color temperature  
**27K**    2700K color temperature  
**30K**    3000K color temperature  
**40K**    4000K color temperature

### 4. AVAILABLE OPTIONS

**90R<sup>0</sup>**    90 CRI (3000K only)  
**BAC<sup>1</sup>**    Buy American Compliant  
**DTR<sup>4</sup>**    Triac (Line Voltage) Dimming (120V)  
 (All except B06)  
**ES<sup>6</sup>**    ENERGY STAR® (Not available in 90 CRI)  
**FCL<sup>7</sup>**    French Canadian Labels  
**TMP**    Tamper Resistant Hardware and Tool  
**T24<sup>9</sup>**    Title 24 JA8 Compliant (B12 in 3000K only)

**Notes:** (0) **90R** - cannot be combined with ES. (1) **BAC** - cannot be combined with FCL. (2) **BBI/BBS/BBC** - cannot be combined with ECW, EXT, or T24.  
 (3) **BLD** - includes integral OCC sensor (do not combine with OCC option). Cannot be combined with DTR or T24. (4) **DTR** - cannot be combined with BLD or T24.  
 (5) **ECW** - cannot be combined with BBI, BBC, or DTR. (6) **ES** - cannot be combined with 90R or T24. (7) **FCL** - cannot be combined with BAC or T24.  
 (8) **OCC** - integral ON/OFF occupancy sensor. (9) **T24** - includes JA8 labeling and 90 CRI LEDs (do not combine with 90R option). Cannot be combined with BBI, BBC, BBS, BLD, DTR, ES, or FCL. (10) **BBS** - cannot be combined with BLD, ECW, EXT, OCC, or T24. (11) **PCH/PC4** - cannot be combined with BLD or OCC.  
**Add'l Notes:** \***BBI/BBS/BBC** - standard BBI (and BBS) option has a minimum operating temperature of 10C/50F. BBC option has a minimum operating temperature of -20C/-4F. \*\***BLD** - integral OCC sensor with onboard control. 1: Motion is detected, illuminate to 100%. 2: Motion no longer detected, dim to 50% (factory default), 30%, 20% or 10%. 3: Remain in continuous dimmed state (factory default) or turn off after set period.

### Specifications and dimensions subject to change without notice.

Consult your Brownlee Lighting representative for availability and ordering information.