



BMB diffuser



Custom YLW

2612 LED

The customizable Highlighter high performance pendant is a solution to a variety of challenging lighting applications. This unit features a one-piece frosted acrylic outer shell, with a variety of decorative film and pattern options which are bonded to the inner side of the drum. The unit is offered in multiple sizes ranging from 24 inches to 48 inches and can be easily cleaned given its protective acrylic outer shell construction. Consider this a vibrant choice to liven up lobbies, schools, medical facilities, libraries, club houses, conference rooms and more. Refer to the 2362 for a surface mount version of this product.

FINISHES

BL	BZ	GM	MB	MG	NT	WH
----	----	----	----	----	----	----

HIGHLIGHTER PENDANT

STANDARD SPECIFICATIONS

DIFFUSER

The UV stabilized designer drum is offered in a variety of vibrant colors and patterns which are bonded to the inner side of the frosted acrylic drum. The base (bottom) of the drum is constructed with high transmission white acrylic. Chrome trim at the top and bottom of the sidewall. The shade can be wiped clean with a damp cloth. See accessories section for Top Cover Set.

HOUSING

Formed, cold rolled steel design, finished in a high reflectance powder coat white.

LED PERFORMANCE - 3500K STANDARD

120-277V - 3500K, L80 rating - 60,000 hrs - L70 rating (projected) - 100,000 hrs
Amperage rated @ 110V input
Operating ambient temperature: -20°C / -4°F - 40°C / 104°F

Delivered 3500K lumens noted. Consult Brownlee.com for performance of all CCTs.
24 Size: R34 - 34W nominal, .28 A input - 4569 lm. Dimmable (0-10V). 82 CRI standard.
24 Size: R49 - 49W nominal, .41 A input - 6071 lm. Dimmable (0-10V). 82 CRI standard.
36 Size: C49 - 45W nominal, .40 A input - 5878 lm. Dimmable (0-10V). 82 CRI standard.
36/48 Size: H63 - 63W nominal, .53 A input - 7429 lm. Dimmable (0-10V). 90+ CRI standard.

*Testing performed on White Acrylic shade option. Darker shade options decrease lumen output.

MOUNTING

Directly to j-box (by others). Mounting hardware included.

WARRANTY

5 year limited warranty on this LED product. Consult factory for details.

Diffuser Insert Options
(bonded to inner side of frosted acrylic drum)



NT finish, WHA diffuser, CC1 suspension

SUSPENSION SYSTEM

The 2612 Series is available in multiple colors and four suspension methods:

CC1 - Cord & Single Cable: Both the power cord and aircraft cable can be trimmed in the field. See optional ordering code CE1 and CE2 for extended 10' and 20' drops. Recommended for pendants up to 36"Ø only.

CC3 - Cord & Three Cable: Both the power cord and aircraft cables can be trimmed in the field. See optional ordering code CE1 and CE2 for extended 10' and 20' drops.

SCM - Stem & Cable Mount: Steel stem in your choice of finish with three aircraft cables. The standard overall height (OAH) can be extended with additional stem sections in 1' and 2' intervals - see accessories section.

SSM - Single Stem Mount: Traditional pendant style. Steel stem in your choice of finish. The standard overall height (OAH) can be extended with additional stem sections in 1' and 2' intervals - see accessories section. Recommended for pendants up to 36"Ø only.



WH finish, WHA diffuser, SCM suspension



NT finish, BMB diffuser, SSM suspension



NT finish, BLU diffuser, CC3 suspension

2: Motion no longer detected, dim to set level. 3: Remain in continuous dimmed state or turn off after set period. Config. via onboard dip switches.

Specifications subject to change without notice.

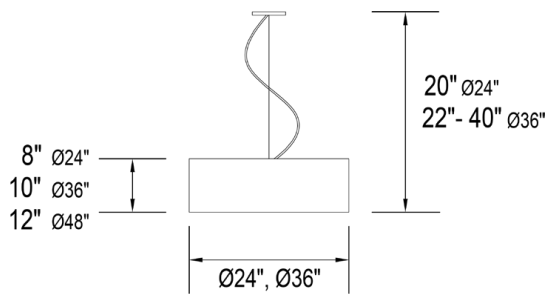

CC1 suspension

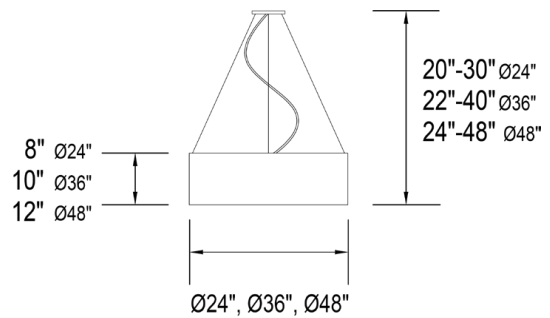

CC3 suspension

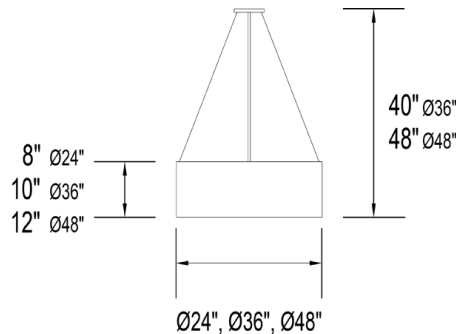

SCM suspension

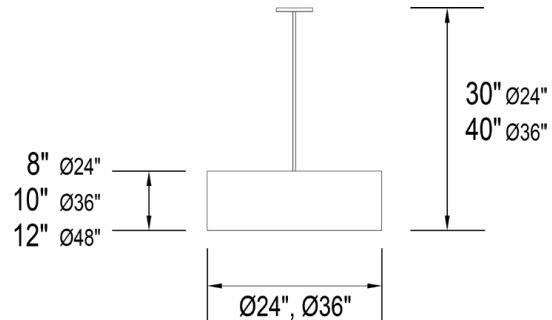

SSM suspension



ORDERING INFORMATION

2612

Model 2. 3. 4. 5. 6. 7. 8. (if required)

2. SIZE	3. FINISH	4. WATTAGE	5. DIFFUSER	7. COLOR TEMPERATURE
24 24" dia.	STANDARD	24 SIZE	WHA White Acrylic	35K 3500K standard color temperature
36 36" dia.		R34 34W R Series LED	BLU Blue	27K 2700K color temperature (All except H63)
48 48" dia.	CC1 & CC3	R49 49W R Series LED	BMB Bamboo	30K 3000K color temperature
	BL Black		LMG Lime Green	40K 4000K color temperature
	NT Nickel Tone	36 SIZE	LRD Light Red	
	WH White	C49 45W C Series LED	ORN Orange	
		H63 63W H Series LED	Custom colors available - typical MOQ 10-15 units. Contact factory.	
	SCM & SSM	48 SIZE		
	BL Black	H63 63W H Series LED	6. SUSPENSION	8. AVAILABLE OPTIONS
	BZ Bronze		CC1 Cord & Single Cable (24, & 36 size only)	90R⁰ 90 CRI (R-Series Wattages: 30K & 35K only) (C-Series Wattages: 30K only)
	GM Gun Metal	*Contact factory for higher lumen packages.	CC3 Cord & Three Cable	AMF Antimicrobial Finish (BL, NT, WH only) (See AMF note)
	MB Metallic Bronze		SCM Stem & Cable Mount	BAB¹ Build America, Buy America Compliant (BABAA)
	MG Metallic Gold		SSM Single Stem Mount (24, & 36 size only)	BAC¹ Buy American Compliant (BAA)
	NT Nickel Tone			CE1 3' - 10' Cord/Cable Extension (CC1 & CC3 only)
	WH White			CE2 10' - 20' Cord/Cable Extension (CC1 & CC3 only)
	ANTIMICROBIAL			DTR⁴ Triac (Line Voltage) Dimming (120V)
	Available in a select number of finishes. Refer to the Options section of this sheet for details ("AMF").			FCL⁷ French Canadian Labels
				T24⁹ Title 24 JA8 Compliant (R-Series Wattages: 30K & 35K only) (C-Series Wattages: 30K only) (Unavailable in H63)

ACCESSORIES (field installed - order separately)

390001xx	SCM Extension Kit: includes (1) 1' stem and (2) 2' stems. 5' combined max. Specify finish (xx)
390002xx	SSM Extension Kit: includes (1) 1' stem and (2) 2' stems. 5' combined max. Specify finish (xx)
320029WHA	Top Cover Set: 24 size, White Acrylic
320031WHA	Top Cover Set: 36 size, White Acrylic
320033WHA	Top Cover Set: 48 size, White Acrylic

AMF Note: Antimicrobial powder coat is applied to the exposed metal fixture parts and can inhibit the growth of mildew and spoilage causing microbes on the finish. Does not apply to diffuser.

Universal Footnotes (only applies if superscript is shown in Options section): (0) **90R** - All LEDs/CCTs are being transitioned to 90 CRI standard over 2025. Inquire for this model's availability. (1) **BAC/BAB** - www.brownlee.com/resources/usa. (2) **BBI/BBC** - cannot combine with ECW or EXT. (3) **BLD** - integral microwave motion sensor (step-dim). Cannot combine with DTR. (4) **DTR** - cannot combine with BLD. (5) **ECW** - cannot combine with BBI, BBC, or DTR. (7) **FCL** - cannot combine with BAC. (8) **OCC** - integral microwave motion sensor (ON/OFF). (9) **T24** - includes JA8 labeling and 90 CRI LEDs. (10) **PCH/PC4** - cannot combine with BLD or OCC.
Add'l Notes: ***BBI/BBC** - BBI minimum operating temp: 10C/50F unless otherwise stated. BBC minimum operating temp: -20C/-4F.
****BLD** - integral microwave motion sensor with step-dim control. 1: Motion is detected, illuminate to 100%. 2: Motion no longer detected, dim to set level. 3: Remain in continuous dimmed state or turn off after set period. Config. via onboard dip switches.
Specifications subject to change without notice.