

BREEZE-RD

STANDARD SPECIFICATIONS

PAN

Cold rolled steel, formed in a die, finished with an electroplated brushed nickel coating that will withstand most nicks and scratches.

DIFFUSER

Translucent, UV stabilized white acrylic with optional White Linen fabric material bonded to the walls, allowing for ease of cleaning with a dry or damp cloth.

LED PERFORMANCE - 3500K STANDARD

120-277V - 3500K, 82 CRI - L80 rating - 60,000 hrs - L70 rating (projected) - 100,000 hrs

Amperage rated @ 110V input

Operating ambient temperature: -20°C / -4°F - 40°C / 104°F

Delivered 3500K lumens noted. Consult Brownlee.com for performance of all CCTs.

B12 - 12W nominal, .10 A input - 1414 lm. Dimmable (0-10V).

C17 - 16W nominal, .15 A input - 2043 lm. Dimmable (0-10V).

C24 - 23W nominal, .20 A input - 2803 lm. Dimmable (0-10V).

MOUNTING

Directly to j-box (by others). Mounting hardware included.

FINISH

The standard finish is a sturdy electroplated brushed nickel. Options include all Brownlee paint finishes. Plated finishes such as Brushed Nickel are suitable for indoor applications only. Installation outdoors voids the Brownlee Limited Warranty.

WARRANTY

5 year limited warranty on this LED product. Consult factory for details.

PROJECT:

MODEL #:

FIXTURE TYPE:



BN finish, WHA diffuser



BZ finish, WHL diffuser

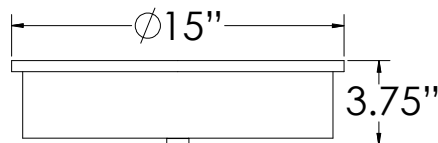

DAMP



ORDERING INFORMATION

2335

Model

2.

3.

4.

5.

6. (if required)

2. FINISH

STANDARD
BN Brushed Nickel

OPTIONAL
BL Black
BZ Bronze
GM Gun Metal
MB Metallic Bronze
MG Metallic Gold
NT Nickel Tone
WH White

CUSTOM

Provide color sample or RAL code to match

3. WATTAGE

B12 12W B Series LED

C17 16W C Series LED

C24 23W C Series LED

4. DIFFUSER

WHA White Acrylic

WHL White Linen

5. COLOR TEMPERATURE

35K 3500K standard color temperature

27K 2700K color temperature

30K 3000K color temperature

40K 4000K color temperature

6. AVAILABLE OPTIONS

90R⁰ 90 CRI (3000K only)

BAC¹ Buy American Compliant (BAA)

BLD^{3}** Bi-Level Dimming

DTR⁴ Triac (Line Voltage) Dimming (120V)

FCL⁷ French Canadian Labels

OCC⁸ Occupancy Sensor

T24⁹ Title 24 JA8 Compliant (B12 & C24 in 3000K only)

Universal Footnotes (only applies if superscript is shown in Options section): (0) **90R** - All LEDs/CCTs are being transitioned to 90 CRI standard over 2025. Inquire for this model's availability. (1) **BAC/BAB** - www.brownlee.com/resources/usa. (2) **BBI/BBC** - cannot combine with ECW or EXT. (3) **BLD** - integral microwave motion sensor (step-dim). Cannot combine with DTR. (4) **DTR** - cannot combine with BLD. (5) **ECW** - cannot combine with BBI, BBC, or DTR. (7) **FCL** - cannot combine with BAC. (8) **OCC** - integral microwave motion sensor (ON/OFF). (9) **T24** - includes JA8 labeling and 90 CRI LEDs. (10) **PCH/PC4** - cannot combine with BLD or OCC.

Add'l Notes: ****BBI/BBC** - BBI minimum operating temp: 10C/50F unless otherwise stated. BBC minimum operating temp: -20C/-4F.

****BLD** - integral microwave motion sensor with step-dim control. 1: Motion is detected, illuminate to 100%.

2: Motion no longer detected, dim to set level. 3: Remain in continuous dimmed state or turn off after set period. Config. via onboard dip switches.

Specifications subject to change without notice.



BROWNLEE
LIGHTING

www.brownlee.com

REVISED
2024.12.19