

7145

STANDARD SPECIFICATIONS

DIFFUSER

Architectural styling and an injection molded UV stabilized polycarbonate design highlight this prismatic diffuser.

HOUSING

Rugged die-cast aluminum design with a rubber gasket to seal the fixture for a variety of environments.

ELECTRICAL

Quad CFL, 4-pin G24q Base 2700K lamp - 120-277V Electronic HPF Ballast
Triple CFL, 4-pin GX24Q Base 2700K lamp - 120-277V Electronic HPF Ballast

Fluorescent fixtures utilizing an occupancy sensor should include a programmed start HPF ballast. Fluorescent lamps powered by instant start or rapid start ballasts, or GU24 base compact fluorescent lamps used in this application may result in severely shortened lamp life and/or ballast damage.

MOUNTING

The 7145 series is designed for direct mounting to exterior surfaces and features both rear and surface conduit entry.

FINISH

This series is available in a standard bronze polyester powder coat.

DISCONTINUED
CHECK FACTORY STOCK

PROJECT:

MODEL #:

FIXTURE TYPE:

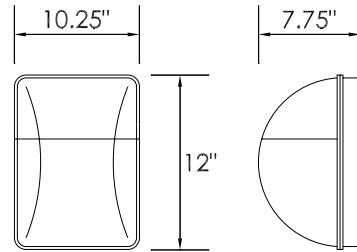

WET

ORDERING INFORMATION

7145 -

Model

2.

3. (if required)

2. WATTAGE

226Q 2-26W Quad CFL, elec. HPF

42T 1-42W Triple CFL, elec. HPF

242T 2-42W Triple CFL, elec. HPF

3. AVAILABLE OPTIONS

BAC Buy American Compliant

BBI¹ Integral Battery Backup (226Q & 42T only)

BBIC¹ Integral Battery Backup, Cold Weather (226Q & 42T only)

ES ENERGY STAR® (Q only)

PO1 Photo Control (120V)

PO2 Photo Control (208V, 240V, 277V)

1) BBI & BBR options have an operating temperature of +32°F to +122°F. BBIC & BBRC options have an operating temperature of -4°F to +131°F. BBR & BBRC are field installed options available on all HPF fluorescent (CFL & T8) fixtures, except those with dimming ballasts. The maximum distance between the battery and the fixture is 10' for HPF ballasts.

Specifications and dimensions subject to change without notice.

Consult your Brownlee Lighting representative for availability and ordering information.