

ARMOR [LARGE]

DISCONTINUED
REFER TO MODEL # 7037
FOR ALTERNATE



27K/30K ONLY

PROJECT:

MODEL #:

FIXTURE TYPE:

STANDARD SPECIFICATIONS

HOUSING

The large sized Dark Sky cutoff wall pack design features a die-cast aluminum housing. The hinged door is fastened over the continuous rubber seal with stainless steel hardware.

REFLECTOR

Formed aluminum, secured in position with hardware.

LENS

Clear, tempered glass is held into the cast door with stainless steel brackets and a sturdy, rubber gasket.

LED PERFORMANCE - 3500K STANDARD

120-277V - 3500K, 82 CRI - L80 rating - 60,000 hrs - L70 rating (projected) - 100,000 hrs

Amperage rated @ 110V input

Operating ambient temperature: -20°C / -4°F - 50°C / 122°F

Delivered 3500K lumens noted. Consult Brownlee.com for performance of all CCTs.

C37 - 35W nominal, .30 A input - 5017 lm. Dimmable (0-10V).

C49 - 45W nominal, .40 A input - 6761 lm. Dimmable (0-10V).

D30 - 30W nominal, .28 A input - 3070 lm. Non-dimming.

D56 - 56W nominal, .80 A input - 6135 lm. Non-dimming.

MOUNTING

The 7039 is designed to be mounted directly to the surface, and wired with rear conduit entry, or surface conduit into the side entry ports.

FINISH

This series is available in a standard bronze polyester powder coat.

WARRANTY

5 year limited warranty on this LED product. Consult factory for details.

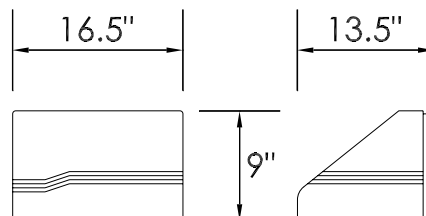

ORDERING INFORMATION



WET



7039

Model

2.

3.

4. (if required)

2. WATTAGE

C37 35W C Series LED

C49 45W C Series LED

D30 30W D Series LED

D56 56W D Series LED

3. COLOR TEMPERATURE

35K 3500K standard color temperature

27K 2700K color temperature (C Series only)

30K 3000K color temperature (C Series only)

40K 4000K color temperature (C Series only)

4. AVAILABLE OPTIONS

BAC¹ Buy American Compliant

BBC Integral Battery Backup, Cold Weather (C Series only)

DTR⁴ Triac (Line Voltage) Dimming (120V) (C Series only)

ECW⁵ Extreme Cold Weather (-40°C / -40°F min.)

ES⁶ ENERGY STAR® (C Series only)

FCL⁷ French Canadian Labels

PO1 Photo Control (120V)

PO2 Photo Control (208, 240, 277V)

T24⁹ Title 24 JA8 Compliant (C49 in 3000K only)

Notes: (0) 90R - cannot be combined with ES. (1) BAC - cannot be combined with FCL. (2) BBI/BBS/BBC - cannot be combined with ECW or EXT.

(3) BLD - includes integral OCC sensor (do not combine with OCC option). Cannot be combined with DTR. (4) DTR - cannot be combined with BLD or T24.

(5) ECW - cannot be combined with BBI, BBC, or DTR. (6) ES - cannot be combined with 90R or T24. (7) FCL - cannot be combined with BAC.

(8) OCC - integral ON/OFF occupancy sensor. (9) T24 - includes JA8 labeling and 90 CRI LEDs (do not combine with 90R option). Cannot be combined with DTR or ES.

(10) BBS - cannot be combined with BLD, ECW, EXT, or OCC. (11) PCH/PC4 - cannot be combined with BLD or OCC.

Add'l Notes: *BBI/BBS/BBC - standard BBI (and BBS) option has a minimum operating temperature of 10°C/50°F. BBC option has a minimum operating temperature of -20°C/-4°F. **BLD - integral OCC sensor with onboard control. 1: Motion is detected, illuminate to 100%. 2: Motion no longer detected, dim to 50%, 30%, 20% or 10%. 3: Remain in continuous dimmed state or turn off after set period.

Specifications and dimensions subject to change without notice.

Consult your Brownlee Lighting representative for availability and ordering information.



REVISED
2022.10.04