

# 7033



Large architectural wall light has aluminum housing and borosilicate glass diffuser for high-wattage, high-performance applications such as perimeter lighting.

## STANDARD SPECIFICATIONS

**HOUSING:** Die-cast aluminum, bronze painted finish

**DIFFUSER:** Clear prismatic borosilicate glass

**BALLAST:**

- 120V NPF Electronic
- 120-277V HPF Electronic
- Multi-tap HPF Magnetic

**LAMP:**

- Triple CFL, 4-pin GX24Q Base 2700K
- High Pressure Sodium, Mogul Base
- Metal Halide, Mogul Base, EISA Compliant

<b>PROJECT:</b>
<b>MODEL #:</b>
<b>FIXTURE TYPE:</b>

## DISCONTINUED

CHECK FACTORY STOCK

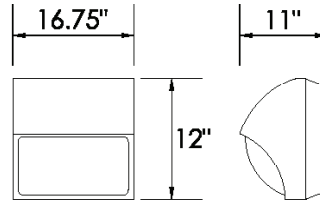

## ORDERING INFORMATION

**7033** - \_\_\_\_\_ - \_\_\_\_\_  
Model            2.                            3. (if required)

### 2. WATTAGE

**226Q** 2-26W Quad CFL, elec. NPF

**42T** 1-42W Triple CFL, elec. HPF

**242T** 2-42W Triple CFL, elec. HPF

**250S** 250W HPS, Multi-tap HPF

**400S** 400W HPS, Multi-tap HPF

**250M** 250W MH, Multi-tap HPF

**320M** 320W MH, Multi-tap HPF

**400M** 400W MH, Multi-tap HPF

### 3. AVAILABLE OPTIONS

- BAC** Buy American Compliant
- BBI** Integral Battery Backup (Q & T only)
- BBIC** Integral Battery Backup, Cold Weather (Q & T only)
- ES3** ENERGY STAR® (elec., NPF) (Q only)
- ES4** ENERGY STAR® (elec., HPF) (Q only)
- PO1** Photo Control (120 volt)
- PO2** Photo Control (208,240,277 volt)
- QR** Quartz Re-strike (S & M only)
- UNV** 120-277V (50/60 Hz), elec. HPF (Q only)

#### ACCESSORIES (field installed)

- BBR** Remote Battery Backup (Q & T only)
- BBRC** Remote Battery Backup, Cold Weather (Q & T only)
- WG** Wire Guard

**Note:** BBI and BBR options have an operating temperature of +32°F to +122°F. Cold weather options BBIC and BBRC have an operating temperature of -4°F to +131°F.