

7016 LED **DISCONTINUED**

STANDARD SPECIFICATIONS

HOUSING

Die-cast aluminum housing designed for rugged applications. The hinged door is fastened over the continuous rubber seal with stainless steel hardware. Fixture mounts with a threaded, adjustable knuckle.

REFLECTOR

Formed aluminum, secured in position with hardware.

LENS

Clear, tempered glass fastened into the hinged door with a continuous seal.

LED PERFORMANCE - 3500K STANDARD

120-277V - 3500K, 82 CRI - L80 rating - 60,000 hrs - L70 rating (projected) - 100,000 hrs
 Amperage rated @ 110V input
 Operating ambient temperature: -20°C / -4°F - 40°C / 104°F

Delivered 3500K lumens noted. Consult Brownlee.com for performance of all CCTs.

B12 - 12W nominal, .10 A input - 1405 lm. Dimmable (0-10V).

C09 - 9W nominal, .10 A input - 991 lm. Dimmable (0-10V).

C17 - 16W nominal, .15 A input - 2030 lm. Dimmable (0-10V).

C24 - 23W nominal, .20 A input - 2785 lm. Dimmable (0-10V).

MOUNTING

The 7016 is designed to be installed in a threaded collar, and the light can be aimed at the end user's preference.

FINISH

This series is available in a standard bronze polyester powder coat.

WARRANTY

5 year limited warranty on this LED product. Consult factory for details.

ORDERING INFORMATION

7016 - - - -
 Model 2. 3. 4. (if required)

2. WATTAGE

B12 12W B Series LED
C09 9W C Series LED
C17 16W C Series LED
C24 23W C Series LED

PROJECT:
MODEL #:
FIXTURE TYPE:

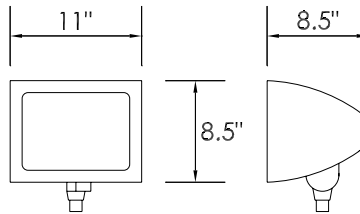

WET



3. COLOR TEMPERATURE

35K 3500K standard color temperature
27K 2700K color temperature
30K 3000K color temperature
40K 4000K color temperature

4. AVAILABLE OPTIONS

BAC¹ Buy American Compliant
DTR⁴ Triac (Line Voltage) Dimming (120V)
ECW⁵ Extreme Cold Weather (-40°C / -40°F min.)
ES⁶ ENERGY STAR®
FCL⁷ French Canadian Labels
PO1 Photo Control (120V)
PO2 Photo Control (208, 240, 277V)
T24⁹ Title 24 Compliant (B12 & C24 in 3000K only)

ACCESSORIES (field installed - order separately)
153020BZ Glare Shield

Notes: (0) 90R - cannot be combined with ES or T24 (1) BAC - cannot be combined with FCL (2) BBI/BBS/BBC - cannot be combined with DTR, ECW, EXT, or T24 (3) BLD - cannot be combined with DTR, OCC, or T24 (4) DTR - cannot be combined with BBI, BBC, BBS, BLD or T24 (5) ECW - cannot be combined with BBI, BBC, or DTR (6) ES - cannot be combined with 90R, FCL, or T24 (7) FCL - cannot be combined with BAC, ES, or T24 (8) OCC - cannot be combined with BLD (9) T24 - cannot be combined with 90R, BBI, BBC, BBS, BLD, DTR, ES, or FCL (10) BBS - cannot be combined with BLD, DTR, ECW, EXT, OCC, or T24 (11) PCH/PC4 - cannot be combined with BLD or OCC

Add'l Notes: *BBI/BBS/BBC - standard BBI (and BBS) option has a minimum operating temperature of 10C/50F. BBC option has a minimum operating temperature of -20C/-4F. **BLD - Bi-Level Dimming is field adjustable from 100% to a dimmed light level of 10, 20, 30, or 50%. All units are factory set at 50%.

Specifications and dimensions subject to change without notice.

Consult your Brownlee Lighting representative for availability and ordering information.

