

# 1050 LED

**DISCONTINUED**  
CHECK FACTORY STOCK

## STANDARD SPECIFICATIONS

### HOUSING

The injection molded aluminum housing is designed to withstand rugged environments. The cover plate is punched from galvanized steel.

### DIFFUSER

The sturdy, injection molded, UV stabilized polycarbonate diffusers is available in clear prismatic, and is attached to the housing with stainless steel hardware.

### LED PERFORMANCE - 3500K STANDARD

120-277V - 3500K, 82 CRI - L80 rating - 60,000 hrs - L70 rating (projected) - 100,000 hrs  
Amperage rated @ 110V input  
Operating ambient temperature: -20°C / -4°F - 40°C / 104°F

Standard 3500K source lumens noted. Consult Brownlee.com for performance of all CCTs.  
B12LED - 12W nominal, .10 A input - 1422 lm - 120 lm/W

### MOUNTING

Directly to j-box (by others). Mounting hardware included.

### FINISH

The 1050 series is available in three standard colors, or any of the Brownlee finishes as an option.

### WARRANTY

5 year limited warranty on this LED product. Consult factory for details.

<b>PROJECT:</b>
<b>MODEL #:</b>
<b>FIXTURE TYPE:</b>



WH finish



BL finish

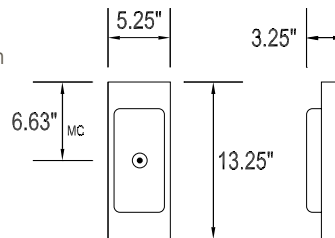

WET



## ORDERING INFORMATION

**1050** - \_\_\_\_\_ - \_\_\_\_\_ - \_\_\_\_\_  
Model                      2.                      3.                      4. (if required)

### 2. FINISH

#### STANDARD

**BZ** Bronze

#### OPTIONAL

**BL** Black  
**BT** Brass Tone  
**GM** Gun Metal  
**MB** Metallic Bronze  
**NT** Nickel Tone  
**PL** Platinum  
**WH** White

#### CUSTOM

Provide color sample or RAL code to match

### 3. WATTAGE

**B12LED** 2-B Series boards

### 4. AVAILABLE OPTIONS

**35K** 3500K standard color temperature  
**27K** 2700K color temperature  
**30K** 3000K color temperature  
**40K** 4000K color temperature  
**90R** 90 CRI (3000K only)  
**BAC** Buy American Compliant  
**DIM** Dimming driver (120-277V) (0-10V dimming control required)  
**DTR** Triac (Line Voltage) Dimming (120V)  
**ECW** Extreme Cold Weather (-40°C / -40°F min.)  
**ES** ENERGY STAR® (Not available in 90 CRI)  
**PO1** Photo Control (120V)  
**PO2** Photo Control (208, 240, 277V)  
**T** Tamper Resistant Hardware and Tool

Specifications and dimensions subject to change without notice.  
Consult your Brownlee Lighting representative for availability and ordering information.



DISCONTINUED  
2017.05.25

# 1050

**DISCONTINUED**  
CHECK FACTORY STOCK

## STANDARD SPECIFICATIONS

### HOUSING

The injection molded aluminum housing is designed to withstand rugged environments. The cover plate is punched from galvanized steel.

### DIFFUSER

The sturdy, injection molded, UV stabilized polycarbonate diffusers is available in clear prismatic, and is attached to the housing with stainless steel hardware.

### ELECTRICAL

CFL, 2-pin GX23 Base 2700K lamp – 120V Magnetic NPF Ballast

Fluorescent fixtures utilizing an occupancy sensor should include a programmed start HPF ballast. Fluorescent lamps powered by instant start or rapid start ballasts, or GU24 base compact fluorescent lamps used in this application may result in severely shortened lamp life and/or ballast damage.

### MOUNTING

Directly to j-box (by others). Mounting hardware included.

### FINISH

The 1050 series is available in three standard colors, or any of the Brownlee finishes as an option.

<b>PROJECT:</b>
<b>MODEL #:</b>
<b>FIXTURE TYPE:</b>



WH finish



BL finish

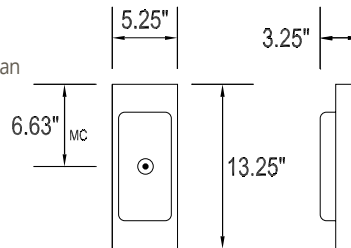

WET



## ORDERING INFORMATION

**1050** -          -          -          -           
Model                      2.                      3.                      4. (if required)

### 2. FINISH

#### STANDARD

**BZ** Bronze

#### OPTIONAL

- AG** Antique Gold
- BL** Black
- BR** Brick
- BT** Brass Tone
- DS** Desert Stone
- GM** Gun Metal
- MB** Metallic Bronze
- NT** Nickel Tone
- OL** Oak Leaf
- PL** Platinum
- RB** Rustic Bronze
- RC** Rustic Copper
- WH** White

#### CUSTOM

Provide color sample or RAL code to match

### 3. WATTAGE

- 13** 1-13W CFL, mag.
- 213** 2-13W CFL, mag.

### 4. AVAILABLE OPTIONS

- BAC** Buy American Compliant
- PO1** Photo Control (120V) (13 only)
- T** Tamper Resistant Hardware and Tool

Specifications and dimensions subject to change without notice.  
Consult your Brownlee Lighting representative for availability and ordering information.