

# 2326

## STANDARD SPECIFICATIONS

### PAN

Cold rolled 22 GA steel, formed in a die, finished in a powder coat high reflectance white paint. The pan features weld nuts for a "twist and hold" installation of the diffuser.

### DIFFUSER

The drum features a high quality UV stabilized white acrylic outer shell. The base (bottom) of the drum features an inset section and is constructed with high transmission white acrylic. The fixture can be cleaned with a damp cloth and mild detergent if needed.

### ELECTRICAL

Quad CFL, 4-pin G24q Base 2700K lamp – 120-277V Electronic HPF Ballast  
 GU24 CFL, 2-prong Base 2700K lamp – 120V Electronic NPF Ballast  
 Circline, G10Q Base 4000K lamp – 120V Electronic NPF Ballast

Brownlee Lighting does not recommend GU24 base lamps for 24 hour operation due to lamp manufacturer specifications.

Fluorescent fixtures utilizing an occupancy sensor should include a programmed start HPF ballast. Fluorescent lamps powered by instant start or rapid start ballasts, or GU24 base compact fluorescent lamps used in this application may result in severely shortened lamp life and/or ballast damage.

### MOUNTING

Directly to j-box (by others). Mounting hardware included.

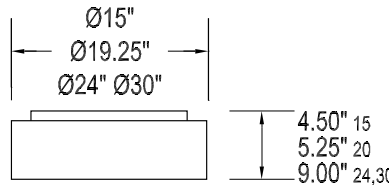

WBK diffuser

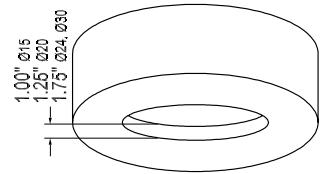

BBI OPTION

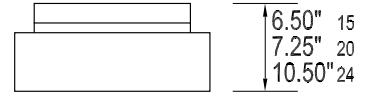

DAMP



## ORDERING INFORMATION

2326

Model                    2.                    3.                    4.                    5. (if required)

### 2. SIZE

15 15" dia.  
 20 19.25" dia.  
 24 24" dia.  
 30 30" dia.

### 3. WATTAGE

**15 SIZE**

**213Q** 2-13W Quad CFL, elec. HPF  
**313Q** 3-13W Quad CFL, elec. HPF  
**18Q** 1-18W Quad CFL, elec. HPF  
**218Q** 2-18W Quad CFL, elec. HPF  
**26Q** 1-26W Quad CFL, elec. HPF  
**226Q** 2-26W Quad CFL, elec. HPF

**213G** 2-13W GU24 CFL, elec. NPF  
**313G** 3-13W GU24 CFL, elec. NPF  
**18G** 1-18W GU24 CFL, elec. NPF  
**218G** 2-18W GU24 CFL, elec. NPF

**22C** 1-22W Circline, elec. NPF  
**32C** 1-32W Circline, elec. NPF  
**54C** 1-32W & 1-22W Circline, elec. NPF

**20 SIZE**

**413Q** 4-13W Quad CFL, elec. HPF  
**318Q** 3-18W Quad CFL, elec. HPF

### 20 SIZE CONT'D

**226Q** 2-26W Quad CFL, elec. HPF  
**326Q** 3-26W Quad CFL, elec. HPF

**413G** 4-13W GU24 CFL, elec. NPF  
**318G** 3-18W GU24 CFL, elec. NPF

### 24 & 30 SIZE

**413Q** 4-13W Quad CFL, elec. HPF  
**418Q** 4-18W Quad CFL, elec. HPF  
**326Q** 3-26W Quad CFL, elec. HPF  
**426Q** 4-26W Quad CFL, elec. HPF

**332T** 3-32W Triple CFL, elec. HPF  
**432T** 4-32W Triple CFL, elec. HPF

### 4. DIFFUSER

**WA** White Acrylic  
**WBK** Woven Black

### 5. AVAILABLE OPTIONS

**BAC** Buy American Compliant  
**BBI<sup>1</sup>** Integral Battery Backup (Q only, adds 2" to depth)  
**DIM1** Dimming Ballast (120V) (Q only)  
**DIM2** Dimming Ballast (277V) (Q only)  
**ES** ENERGY STAR® (26Q, 226Q, 326Q & 426Q only)

1) BBI & BBR options have an operating temperature of +32°F to +122°F. BBIC & BBRC options have an operating temperature of -4°F to +131°F. BBR & BBRC are field installed options available on all HPF fluorescent (CFL & T8) fixtures, except those with dimming ballasts. The maximum distance between the battery and the fixture is 10' for HPF ballasts.

### Specifications and dimensions subject to change without notice.

Consult your Brownlee Lighting representative for availability and ordering information.